

BD SoloShot™ Mini Syringe Instructions For Use

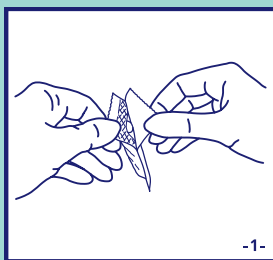

- Check that the syringe package is undamaged and unopened. Discard if damaged or opened.
- Peel open the end of the package and remove the syringe. (See Figure 1)

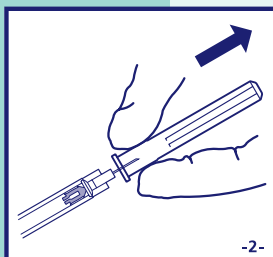

- Wipe the top of the vial with alcohol and allow it to air dry.
- Remove the shield from the needle. (See Figure 2)
Do not move the plunger, and do not try to inject air into the vial, as this will disable the syringe.

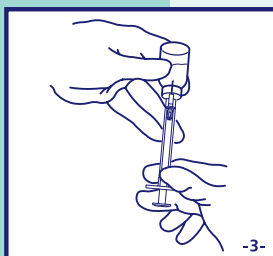

- Pick up the vial and invert it. Insert needle into the vial. (See Figure 3)
Keep the needle tip in the fluid at all times. Do not draw air into the syringe. It may lead to an inaccurate dose. To fill the syringe, slowly pull the plunger all the way back past the dose mark (0.5, 0.1 or 0.05ml) until it COMPLETELY STOPS.

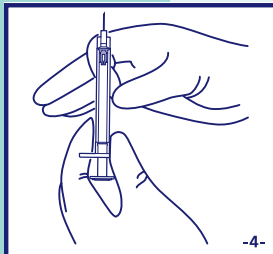

- To remove air bubbles, remove the needle from the vial. Holding the syringe upright, tap the barrel to bring the bubbles towards the tip of the syringe. (See Figure 4)
- Then carefully push the plunger to the dose mark (0.5, 0.1 or 0.05ml), thus expelling the air bubble.

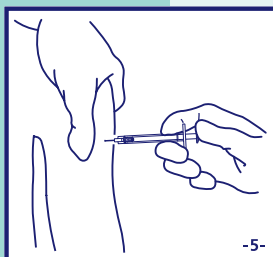

- Administer the injection according to clinical guidelines. (See Figure 5)
- Depress the plunger completely to deliver the dose. The plunger will automatically lock to prevent the syringe from being reused.

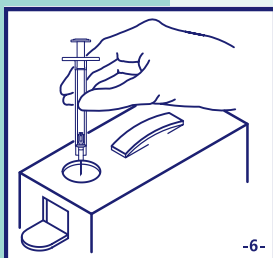

- Place the BD SoloShot™ Mini Syringe immediately in a needle disposal container. (See Figure 6)
Do not reshield.

CAUTION:

To ensure full auto-disable function, carefully follow instructions.

Re-use may lead to infection or other illness injury.