

BD Saf-T-Intima™

Closed IV Catheter System

POINTS TO PRACTICE

1 PREPARATION

- Prepare site according to policy and procedure
- Remove needle cover and inspect unit
- Secure flow control plug or remove it to pre-prime/pre-connect system
- Holding catheter as illustrated, rotate safety barrel to loosen needle
- Make sure bevel is oriented and not covered by the catheter

2 VENIPUNCTURE

- Grasp pebbled side of wings, pinching firmly
- Approach vein slowly at a low angle
- Observe flashback in tubing behind wings

3 ADVANCEMENT

- Upon flashback visualization, lower catheter almost parallel to the skin
- Before threading, advance ENTIRE UNIT slightly to ensure catheter tip is in the vein
- Release wings and stabilize
- Grasp white shield and pull back slightly to recess needle (Fig.3)
- Thread catheter into vein while maintaining skin traction

4 NEEDLE REMOVAL

- Stabilize catheter wings
- Grasp white shield and pull in a straight continuous motion
- Shield will come off, exposing the adapter
- Place needles in a puncture-resistant, leak-proof sharps container.

5 SECUREMENT

- Secure catheter and apply sterile dressing according to policy and procedure

CAUTION REMINDERS

- **Do Not** bend the needle prior to insertion.
- **Never Reinsert Needle** into the catheter as this could shear the catheter.
- **Do Not Use Scissors** at or near the insertion site.
- Place all needles in a puncture-resistant, leak-proof sharps container.

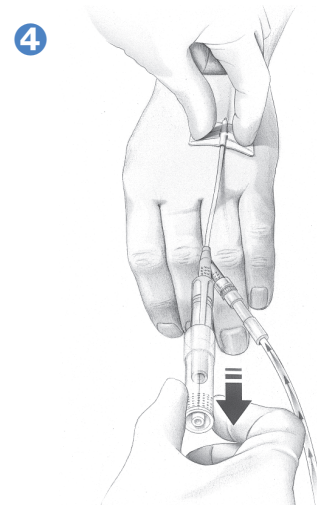
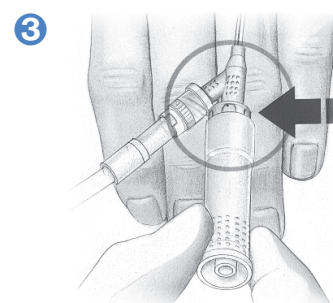
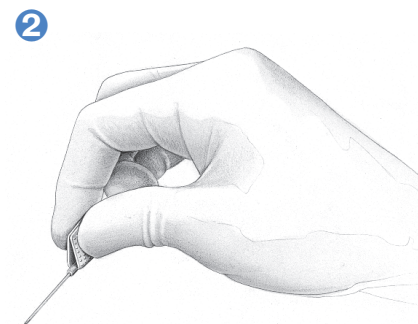
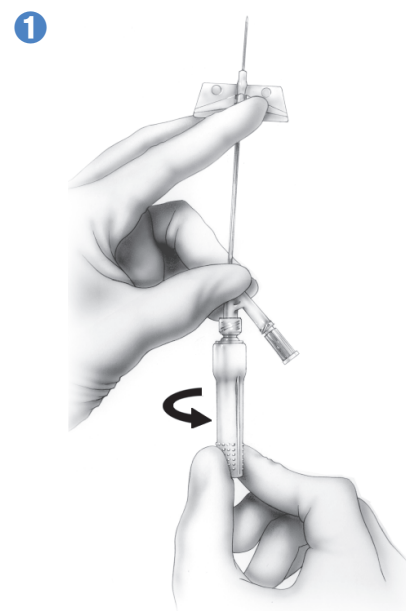

BD Saf-T-Intima™

Closed IV Catheter System

TIPS FOR SUCCESS

MAINTAINING THE BEVEL POSITION

- Make sure the pebble side of catheter wings is in contact with the fingers
- Pinch the wings tightly near the base to 'lock' the bevel position

MAKING A SMOOTH INSERTION

- Make sure catheter is not over needle bevel
- Maintain traction on the skin

INSERTION SUCCESS

- Slow down the speed of insertion
- Lower the initial insertion angle keeping the elbow low
- After flash, lower the angle and advance 1/8 inch
- Make sure tip seal is released by rotating the safety barrel

THREADING WITH EASE

- Make sure to release the tip seal before insertion by rotating the safety barrel
- After flash, lower the angle and advance 1/8 inch
- Do not pull back on the white shield initially more than 1/8 inch
- Maintain traction on the skin

FEELING THE 'POP'?

- Pop causes damage to the vein
- Flash is a better indicator
- Slowing the approach allows the flash to catch up
- Sense the 'loss of resistance' when entering the vein

CONTINUATION OF FLASH

- Normally flash will stop in product without the Y-site configuration

REMOVING THE NEEDLE EASILY

- Make sure to release the tip seal before insertion by rotating the safety barrel
- Open the catheter wings flat
- Do not place finger(s) on the center of the wings
- Only grasp the pebbled end of the white shield
- Without hesitating, pull the needle out in a straight continuous motion until the shield pops off

ACTIVATING THE SAFETY SHIELD

- Only grasp the pebbled end of the white shield
- Without hesitating, pull the needle out in a straight continuous motion until the shield pops off



BD Medical

Sandy, Utah 84070

1-888-237-2762, www.bd.com/infusion

BD, BD Logo and BD Saf-T-Intima are trademarks of Becton, Dickinson and Company. ©BD. D12992-2 B(8-04)