

BD Quikheel™ Lansetler ve BD Microtainer® MAP Otomasyona Uygun Mikrotüp



BD Microtainer® MAP Otomasyona Uygun Mikrotüp

BD Microtainer® MAP Otomasyona Uygun Mikrotüp, ilk tek parça, otomasyona uygun mikrotüp olarak karşınızda.

En hassas hasta grubunuza odaklanın ve **BD Microtainer® MAP**'in örneğinizle ilgilenmesine izin verin.

Eklenen Özellikler;

- Otomasyona uygun delinebilir mikroguard kapak
- Kaşıklama yöntemi ile kan toplamaya uygun entegre ağız
- Barkod yapıştırmaya ve kolay karıştırmaya uygun orjinal tüp boyutu
- Tüp karıştırma sayısını hatırlatan etiket
- Üç farklı dolum hacmi belirteci

BD Quikheel™ Güvenlikli İnsizyon Cihazı



BD Quikheel™ Güvenlikli İnsizyon Cihazı ile yenidoğan topuk insizyonu yaparken kan akışını hızlandırın ve acıyı azaltın. Kolay tek elle kullanımı cerrahi bıçağın hareketi ile tek hamlede hassas ve tutarlı bir kesi sağlar. İşlem esnasında bıçağın cihaz içerisine otomatik hareketi kendinizi ve size güvenenleri beklenmeyen kazalardan korumanızı sağlar..

Eklenen Özellikler;

- PKU analizi için yeteli kan akış miktarı
- Konik izlem penceresi aynı noktaya iki kesi yapılmasını önler
- İnfan ve prematüreler için iki ayrı boy seçeneği
- Standart kesi derinliği ile osteomiyelit riskini azaltma

BD Microtainer® MAP Microtube for Automated Process

Capillary Blood Collection Methods

Performing a Heel Stick

CLSI H4-A6 Recommended Guidelines*:
1. Warming the infant's heel is essential for pH and Blood Gases.

2. Warming the heel increases arterial blood flow to the site up to seven-fold without burning the skin.

3. Temperature of warming device should be no higher than 42° C. Warming should be three to five minutes.



Select a site identified in the shaded area above.
Cleanse site thoroughly with alcohol. (70/30 by volume, 70%).
Allow skin to air dry.

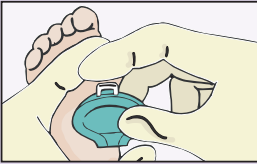

With a gloved hand, place the **BD Quikheel™ Lancet Single-use Safety Incision Device** against the site with the Quikheel logo facing you.
Place the blade slot area securely against the heel.
The incision can be placed at a 90° angle to the length of the foot or parallel to the length of the foot.

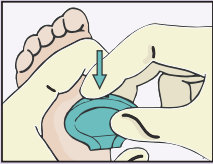

Firmly and completely depress the trigger with your index finger.



After triggering the lancet, remove the lancet and discard it into a biohazard sharps container.

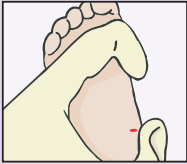

Gently wipe away the first drop of blood with clean, dry gauze pad.
Apply gentle pressure with the thumb and ease intermittently as drops of blood form.
Be sure to apply pressure such that the incision is opened.

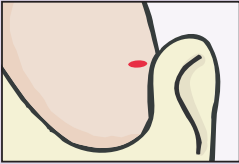

Filling BD Microtainer® Tubes with BD Microgard™ Closure

Obtain necessary supplies.
Confirm the identity of the newborn.
Follow universal precautions.

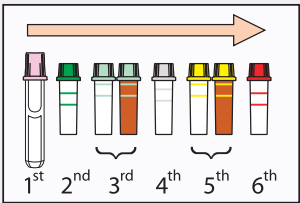

Conduct Heel Stick as outlined in the "Performing a Heel Stick" section above.
The order of draw for microcollection differs from that of venipuncture.
If multiple specimens are to be collected, including EDTA specimens, the EDTA specimen is collected first to ensure adequate volume and accurate hematology test results.
Additive specimens are collected next.
Specimens requiring serum are collected last.
Follow twist assist cap removal instructions above.

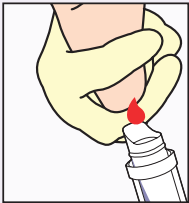
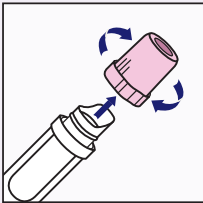

Collect the specimen with the Microtainer tube by allowing the blood to run into the collection funnel while holding at a 30-45° angle.
Ensure that the tube is not scraped over the puncture site.

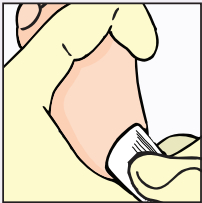

After blood has been collected from the heel of the newborn, the foot should be elevated above the body.
A clean gauze pad should be pressed against the puncture site until bleeding stops.
It is not advisable to apply adhesive bandages over skin puncture sites on newborns.
Invert the BD Microtainer® MAP Microtube for Automated Process according to label instructions. (**K2EDTA – 8x**)
Mix all other Microtainer Tubes with Microgard Closures with the following inversions:
PST – 10x SST – 5x
Glucose – 10x Serum – 0x

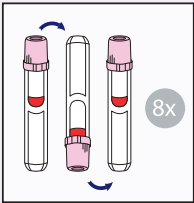

BD Microtainer® Product Offerings

BD Microtainer® MAP Microtube for Automated Process

Reference Number	Description	Packaging Box/Case Quantities
363706	1.0 mg K2EDTA Additive, 13 x 75 mm, Volume 250-500 µL	50/200



BD Microtainer® Quikheel™ Lancets

Reference Number	Width and Depth (mm)	Blood Volume	Color	Packaging Box/Case Quantities
368100	1.75 x 0.85	Low Flow (Premie)	Pink	50/200
368101	2.50 x 1.00	High Flow (Infant)	Teal	50/200



To learn more about BD products and services designed to streamline your lab; send an e-mail to: EMA_PAS@bd.com



*CLSI. H4-A6 Procedures and Devices for the Collection of Diagnostic Capillary Blood Specimens: Approved Standard – Sixth Edition, 2008

BD Microtainer® MAP Microtube for Automated Process

Capillary Blood Collection Methods

Performing a Fingertick Collection

Warm the site.
Use a warm, moist towel or other appropriate warming device (not more than 42°C) for three to five minutes.

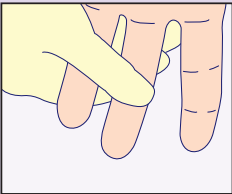

Select the site.
The patient should be sitting or lying down. Have patient hold their hand in a downward position, allowing gravity to help increase blood supply to the hand.

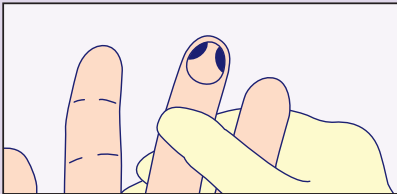

Select finger: middle or ring finger is preferable. Identify the desired puncture site (shaded area) and make sure it is properly cleansed with 70% alcohol according to your facility's established procedures. **The site must be allowed to air dry** in order to provide effective disinfection and to prevent possible hemolysis or erroneous results from residual alcohol.

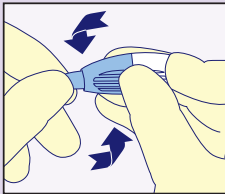

Twist off tab to break the seal and discard.

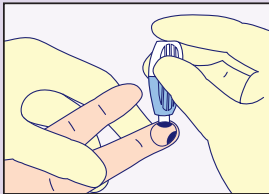

Position the BD Microtainer® Contact-Activated Lancet firmly against the puncture site as illustrated. Hold safety lancet between fingers.

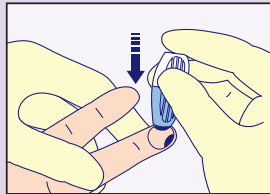

To activate, **press safety lancet firmly against the puncture site**. Do not remove the device from the site until an audible click is heard. Discard used safety lancet into an approved sharps container. Collect the specimen.

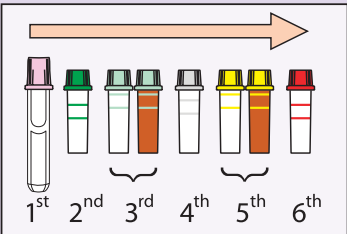

The order of draw for microcollection differs from that of venipuncture. If multiple specimens are to be collected, including EDTA specimens, the EDTA specimen is collected first to ensure adequate volume and accurate hematology test results. Additive specimens are collected next. Specimens requiring serum are collected last. **Follow twist assist cap removal instructions above.**

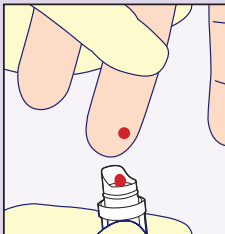
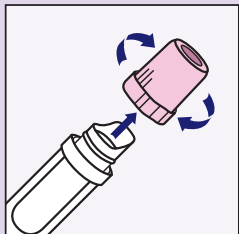

Gently apply intermittent pressure along finger capillaries up to the puncture site. Hold hand below elbow level to obtain the required blood volume. Strong repetitive pressure (milking) must be avoided. **Wipe** away the first drop of blood with a clean dry gauze pad. **Turn** the patient's hand palm down.

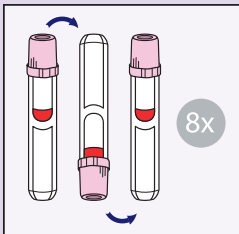

Position the BD Microtainer® MAP Microtube for Automated Process directly beneath the puncture site. Apply gentle, intermittent pressure along finger capillaries to allow them to refill with blood and to help ensure continuous blood flow. Apply gentle pressure at the ends of the puncture site, opening the puncture site slightly, to maximize blood flow. Ensure that the tube is not scraped over the puncture site. Invert tube according to label instructions. **Complete** the procedure. Wipe the site dry and apply direct pressure with a clean gauze pad until the bleeding has stopped. Dispose of all used materials according to your facility's established procedures. Label the tubes and transport them to the lab for processing.

BD Microtainer® Product Offerings

BD Microtainer® MAP Microtube for Automated Process

Reference Number	Description	Packaging Box/Case Quantities
363706	K2EDTA Additive 1.0 mg, 13 x 75 mm, Volume 250-500 µL	50/200



BD Microtainer® Contact-Activated Lancet

Reference Number	Width and Depth (mm)	Blood Volume	Color	Packaging Box/Case Quantities
366594	1.5 mm x 2.0	High Flow	Blue	200/2000



To learn more about BD products and services designed to streamline your lab; send an e-mail to: EMA_PAS@bd.com

CAUTION: Handle all biologic samples and blood collection "sharps" (lancets, needles, luer adapters, and blood collection sets) in accordance with the policies and procedures of your facility. Obtain appropriate medical attention in the event of any exposure to biologic samples (e.g., through a puncture injury) since samples may transmit viral hepatitis, HIV (AIDS), or other infectious diseases. Utilize any safety-engineered feature if the blood collection device provides one. Discard all blood collection "sharps" into biohazard containers approved for their disposal.

BD, BD Logo and all other trademarks are property of Becton, Dickinson and Company.
© 2012 BD



BD Diagnostics - Preanalytical Systems
P.O. Box 52279, Dubai
United Arab Emirates
Tel.: +971 4 337 9525
Fax: +971 4 337 9551
Email: EMA_PAS@bd.com

www.bd.com/vacutainer

BD Quikheel™ Lanset

**Prematüre çocuklar,
yeni doğanlar ve bebeklerden
kan örneđialmak için tasarlanmış,
hafif ve güvenli kan alma cihazı**



Helping all people
live healthy lives



BD Quikheel™ Lanset

Kullanım Kolaylığı

- Konik Temas Yüzeyi ile girişim yerinin daha iyi görülebilmesini sağlar.
- Parmak Konturlu Tasarım'ı sağlam ve hareketsiz bir biçimde tutulmasını sağlar.
- Anlık Tetik İşleyişi kesici ağzın serbest kalmasını önlemek için güvenlik kilidi ihtiyacını ortadan kaldırır.

Hasta Konforu ve Güvenliği

- Ekstra İnce Cerrahi Çelik Bıçak en ince ve en temiz cerrahi kesiği sağlar.
- Sabit Geri Çekilebilir Bıçak, olası yaralanmaları ya da tekrar kullanım ıranını en aza indirir.
- Uygun İnsizyon Derinliği ve Genişliği istenen kan akışını sağlar.

Topuk Delinmesi

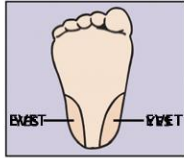

Yukarıdaki şekilde gösterilen renkli alanda bir yer seçin. Bu yeri alkolle iyice temizleyin (%70 alkol). Derinin kurumasını bekleyin.



Eldiven kullanarak, BD Quikheel Lanset'i kendinize dönük olacak şekilde temizlediğiniz alana yerleştirin. Bıçak yuvası alanını topuğa ayak uzunluğuna 90° dik açıyla ya da ayak uzunluğuna paralel olarak yerleştirin.



Tetiğe işaret parmağınızla sıkı ve tam olarak basın.



Lanseti, kullandıktan sonra, biyolojik riskli kesici-delici cisim atık kutusuna atın.



İlk kan damlasını steril bir gazlı bez ya da pamukla yumuşak bir biçimde silin. Başparmağınızla hafif bir basınç uygulayarak kanın damla damla akmasını sağlayın. Kesinin açıldığından emin olunca basıncı uygulayın.



Tanım

BD Quikheel™
Erken Doğmuş Bebek Lanseti
Katalog No. 368100

Derinlik

0.85mm

Genişlik

1.75mm

Ambalaj

50/Kutu, 200/Koli



BD Quikheel™
Bebek Lanseti
Katalog No. 368101

1.0mm

2.50mm

50/Kutu, 200/Koli

BD Vacutainer Teknik Hizmetleri: 1.800.631.0174

BD Müşteri Hizmetleri: 1.888.237.2762

www.bd.com/vacutainer



Tüm biyolojik doku örneklerini ve kan almada kullanılan "kesici-delici" cisimleri (bistüri, iğne, luer adaptörleri ve kan alma setleri) kurumunuzun politika ve prosedürlerine göre elinize alınız. Herhangi bir biçimde biyolojik örneklerle temas etmeyen durumda (örneğin, iğne batması) uygun tıbbi müdahale için başvurun, çünkü biyolojik örneklerle viral hepatitler, HIV (AIDS) ya da başka enfeksiyon hastalıkları bulaşabilir. Kan alma araç-gereciyle birlikte tedarik edilmişse, güvenli özellikleri kullanın. BD, iğne başlıklarının kullanımdan sonra tekrar geçirilmesini önermez, ancak kurumunuzun politika ve prosedürleri farklı olabilir ve her zaman bu politika ve prosedürler izlenmelidir. Tüm kan alma "kesici-delici cisimlerini" kullanımı onaylanmış olan biyolojik riskli atık kutularına atınız.

BD, BD Logo ve diğer tüm markalar Becton, Dickinson and Company mülkiyetindedir. ©2004 BD A.B.D.'de basıldı. 5/03 VS5424-1

BD Diagnostics - Preanalytical Systems
Rüzgarlıbahçe Mah. Ş.Sinan Eroğlu Cad.
No: 6 Akel İş Merkezi A Blok, -3. Kat
34805 Kavacık Beykoz - İstanbul
Tel : +90 216 680 10 02
Fax : +90 216 680 16 55
www.bd.com