

# BD PosiFlush™ Pre-Filled Saline Syringes with BD™ Blunt Plastic Cannula

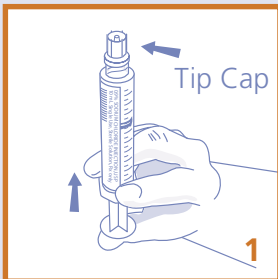

## Usage Guidelines

**Do not place BD PosiFlush Pre-Filled Syringes on a sterile field.**



1. Tear open package at either end and remove syringe.
2. Depress plunger with **tip cap on** to relieve the resistance between the stopper and the barrel (Fig. 1).

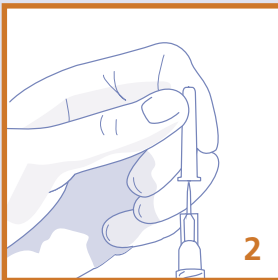

3. Using aseptic technique, remove the syringe tip cap from the FLUSH syringe by twisting it off.

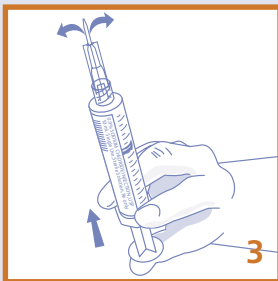

4. Attach BD™ Blunt Plastic Cannula and remove tip shield (Fig. 2).

5. Hold the syringe upright and expel the air in the syringe. **Note: When expelling air/fluid from a syringe, contents exit sideways from the cannula in two separate paths (Fig. 3). Expel air or fluid carefully, directing flow paths away from face or mucous membranes.**

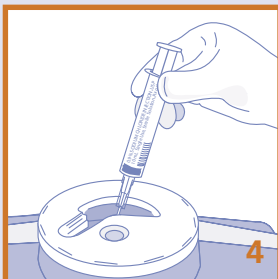

6. Attach the syringe to the injection site and flush following institution's policy.

7. Discard used syringe and any unused portion of the solution according to institution policy (Fig. 4). **Do not reuse.**

**Note:**

2mL, 3mL, 5mL and 10mL BD PosiFlush syringes all have the same diameter as a standard 10mL syringe and may be used for flushing catheters when protocols stipulate use of a 10mL syringe to minimize flush pressure (PSI).