

BD Vacutainer™ Eclipse™ Blood Collection Needle

QUICK REFERENCE CARD

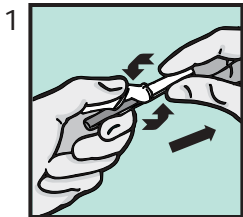

- Holding both colored shields, twist and remove white shield

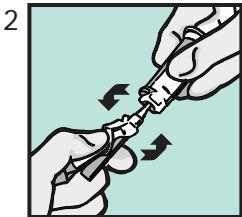

- Screw on holder (if using Pronto™, hold white tab while screwing in needle)

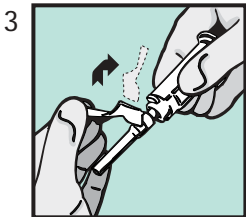

- Rotate safety shield back

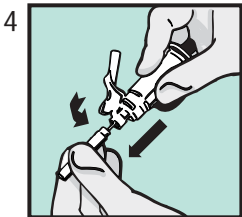

- Twist and pull needle shield straight off

BD Vacutainer™ Eclipse™ Blood Collection Needle

QUICK REFERENCE CARD

5

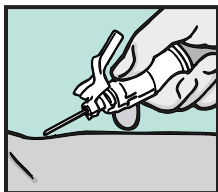

- Perform venipuncture

6

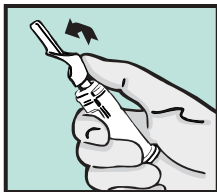

- Firmly push forward on the safety shield, lock into place and inspect

Things to Remember:

- Handle all biologic samples and blood collection sharps (lancets, needles, luer adapters and blood collection sets) according to the policies and procedures of your facility
- Obtain appropriate medical attention in the event of any exposure to biologic samples (for example, through a puncture injury) since they may transmit viral hepatitis, HIV (AIDS) or other infectious diseases
- Utilize any built-in needle protector if the blood collection device provides one
- BD does not recommend reshielding used needles, but the policies and procedures of your facility may differ and must always be followed
- Discard BD Vacutainer Brand Eclipse Blood Collection Needle in the nearest sharps collector. Follow your institution's policy for safe disposal of all medical waste