

BD Vacutainer® Push Button Blood Collection Set with Pre-Attached Holder

Safety from End to End

General Use and Disposal (See package Insert for detailed directions for use)

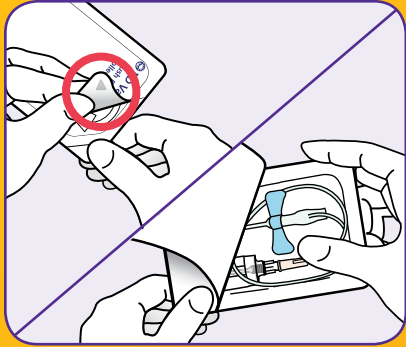

- 1a** Peel back packaging at arrow so that the back end of the wing set is exposed.
- 1b** With thumb and middle finger, grasp the rear barrel of the wingset and remove from package. Be careful to avoid activating the button.

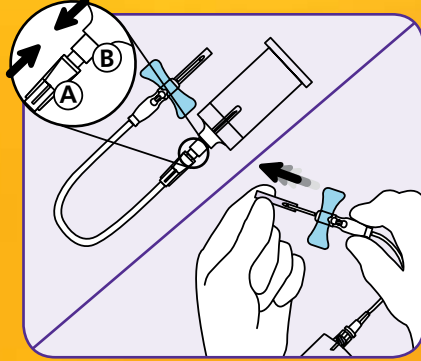

- 2a** Check to ensure that the Female Luer Adapter (A) is securely attached to the Male Luer Adapter (B).
- 2b** Remove needle sheath.

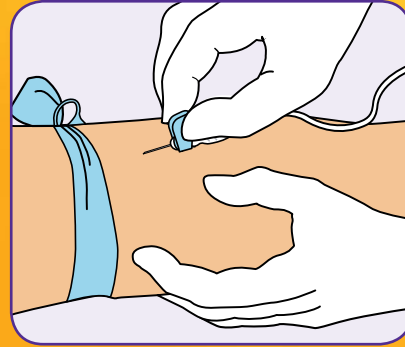

- 3a** With thumb and index finger, grasp the wings together and access vein using standard needle insertion technique.

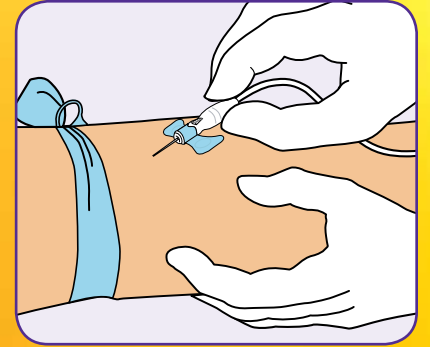

- 3b** If preferred by your institution, the body of the device can be held, instead of the wings, during insertion.

OR

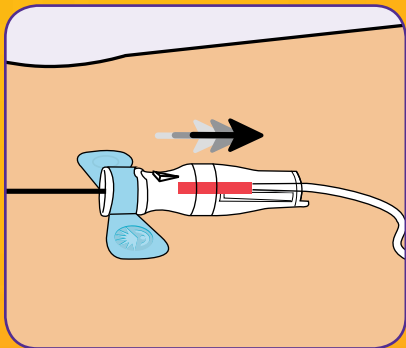

- 4** Proper access to the vein will be indicated by the presence of "flash" directly behind and below the button.

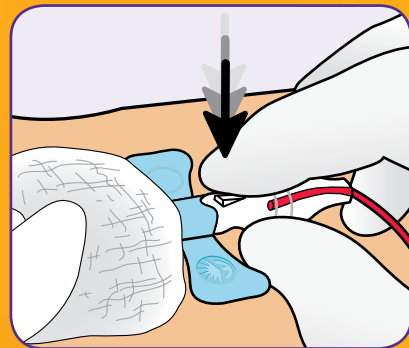

- 5a** **The device is designed to be activated while the needle is still in the patient's vein.** Place your gauze pad on the venipuncture site. Allow gauze pad to cover nose of front barrel. Following the collection procedure, **and while the needle is still in the vein**, grasp the body with the thumb and middle finger. Activate the button with the tip of the index finger. Do not activate with thumb.

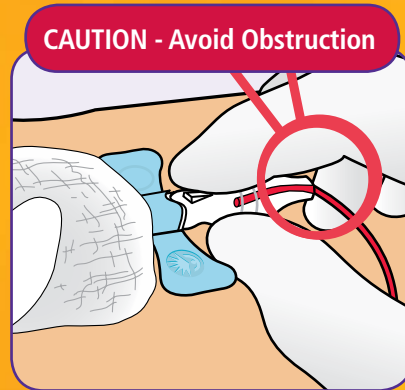

- 5b** To ensure complete and immediate retraction of device, make sure to keep fingers and hands away from the end of the blood collection set during retraction. Do not impede retraction.

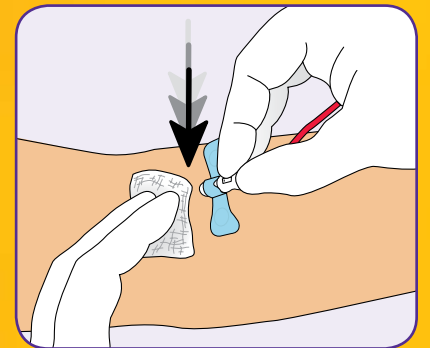

- 6** Apply pressure to the venipuncture site in accordance with your facility's protocol.

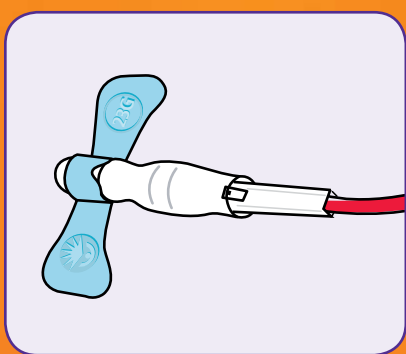

- 7** Confirm that the needle is in the shielded position prior to disposal.

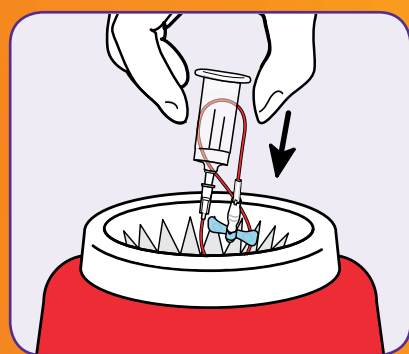

- 8** Discard the entire shielded blood collection set and holder into an approved sharps disposal container.

Ordering Information

BD Vacutainer® Push Button Blood Collection Sets with Pre-Attached Holder

Reference Number	Needle Gauge	Wing Color	Tubing Length	Configuration	Packaging
367352	21	Green	12"	with holder	20/Box 100/Case
368656	23	Blue	12"	with holder	20/Box 100/Case
368659	25	Blue	12"	with holder	20/Box 100/Case

NEW

BD Vacutainer® Push Button Blood Collection Sets

Reference Number	Needle Gauge	Wing Color	Tubing Length	Configuration	Packaging
367338	21	Green	7"	with luer	50/Box 200/Case
367344	21	Green	12"	with luer	50/Box 200/Case
367326	21	Green	12"	without luer	50/Box 200/Case
367336	23	Blue	7"	with luer	50/Box 200/Case
367342	23	Blue	12"	with luer	50/Box 200/Case
367324	23	Blue	12"	without luer	50/Box 200/Case
367341	25	Blue	12"	with luer	50/Box 200/Case
367323	25	Blue	12"	without luer	50/Box 200/Case

BD Technical Services : **1.800.631.0174** (US only)
 BD Customer Service: **1.888.237.2762** (US only)
 BD Customer Service: **1.866.979.9408** (Canada only)
 or visit www.bd.com/vacutainer

CAUTION:

Handle all biologic samples and blood collection "sharps" (lancets, needles, luer adapters, and blood collection sets) in accordance with the policies and procedures of your facility. Obtain appropriate medical attention in the event of any exposure to biologic samples (e.g., through a puncture injury) since samples may transmit viral hepatitis, HIV (AIDS), or other infectious diseases. Utilize any safety engineered feature if the blood collection device provides one. Discard all blood collection "sharps" in biohazard containers approved for their disposal.



Helping all people
live healthy lives

BD Diagnostics
 Preanalytical Systems
 1 Becton Drive
 Franklin Lakes, NJ 07417
www.bd.com/vacutainer