

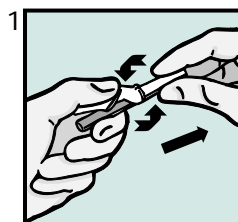

Indispensable to  
human health

## BD Vacutainer™ Eclipse™ Blood Collection Needle

### QUICK REFERENCE CARD



- Holding both colored shields, twist and remove white shield

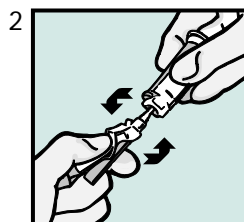

- Screw on holder (if using Pronto™, hold white tab while screwing in needle)

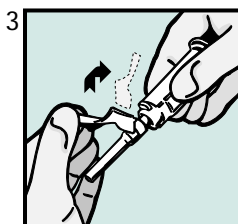

- Rotate safety shield back

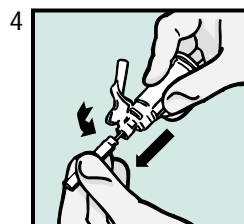

- Twist and pull needle shield straight off

## BD Vacutainer™ Eclipse™ Blood Collection Needle

### QUICK REFERENCE CARD

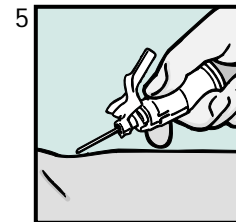

- Perform venipuncture

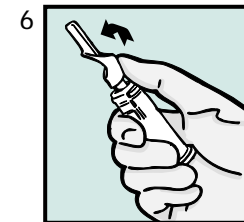

- Firmly push forward on the safety shield, lock into place and inspect

### Things to Remember:

- Handle all biologic samples and blood collection sharps (lancets, needles, luer adapters and blood collection sets) according to the policies and procedures of your facility
- Obtain appropriate medical attention in the event of any exposure to biologic samples (for example, through a puncture injury) since they may transmit viral hepatitis, HIV (AIDS) or other infectious diseases
- Utilize any built-in needle protector if the blood collection device provides one
- BD does not recommend resheilding used needles, but the policies and procedures of your facility may differ and must always be followed
- Discard BD Vacutainer Brand Eclipse Blood Collection Needle in the nearest sharps collector. Follow your institution's policy for safe disposal of all medical waste

All noted trademarks are property of Becton, Dickinson and Company  
1 Becton Drive, Franklin Lakes, NJ 07417 1-888-237-2762 www.bd.com  
©1999 Becton, Dickinson and Company Printed in USA BD10/99-0377