

Acumen IQ Cuff

Setup Guide

Figure 1.

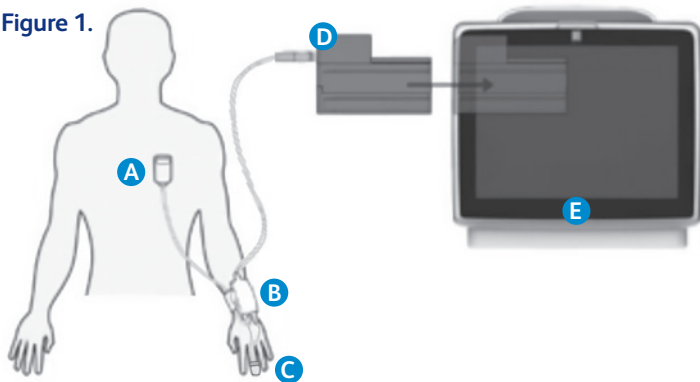

- **Step 1:** Insert the HemoSphere ClearSight module **D** into the large technology slot of monitor **E**. The module will click when properly engaged. Press the power button to turn on the HemoSphere advanced monitor
- **Step 2:** Select the “new patient” button and enter patient data, and then select the “non-invasive” button on the “monitoring mode selection” window
- **Step 3:** Connect the pressure controller **B** to the HemoSphere ClearSight module **D** followed by wrapping the pressure controller band around the patient’s wrist (either wrist can be used, however the non-dominant arm is preferred), attaching the pressure controller to the band (optional) (Figure 2)



Figure 2

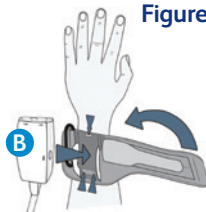

Scan QR code for a video of these setup instructions



- **Step 4:** Open the cuff and place the finger between the green lines, with the cuff centered between the second and third knuckles (Figure 3)

Figure 3.

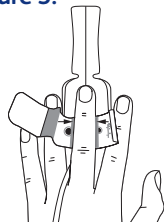

- **Step 5:** Gently lead the cuff cable between the two fingers to the back side of the hand

Figure 4.

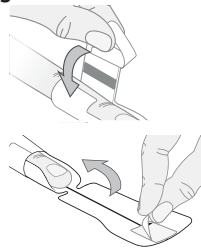

- **Step 6:** Wrap the cuff around the finger; remove the adhesive backing from the finger cuff and secure, do not rotate the cuff after application (Figure 4)

- **Step 7:** Connect the cuff **C** to pressure controller **B** (Figure 5)

Figure 5.

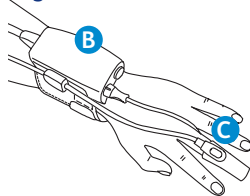

- **Step 8:** If not already connected, connect heart reference sensor (HRS) **A** to pressure controller **B** (Figure 6)

Figure 6.

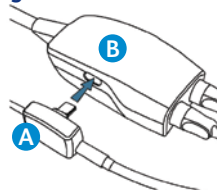

- **Step 9:** Vertically align the lines on both ends of the HRS and touch the on-screen “zero” button and wait for on screen indication that the HRS has been zeroed (Figure 7)

Figure 7.



- **Step 10:** Apply the heart end of the HRS to the patient at the level of the phlebostatic axis by using the HRS clip (Figure 8) and attach the other end of the HRS to the finger cuff (Figure 9)

Figure 8.

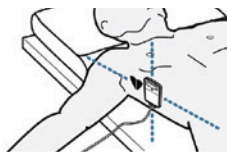

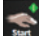
- **Step 11:** Touch the start monitoring icon  on the navigation bar to begin monitoring



- **Step 12:** Touch the home icon  to return to the main monitoring screen

Figure 9

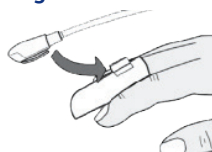

HemoSphere advanced monitoring platform: System navigation

- **Step 1:** Touch the settings icon  and choose “Select Screens” tab  to select the desired monitoring screen view
- **Step 2:** Parameter tiles are located on the right side of the monitoring screen. To change the parameter, touch the displayed parameter label. The tile configuration menu will show the selected parameter highlighted in color. Available parameters appear on the screen without highlights; touch any parameter to select the replacement parameter

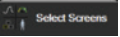

- **Step 3:** To adjust alarms/targets, touch the settings icon  → advanced setup → parameter settings → alarms and targets
- **Step 4:** If desired, HemoSphere advanced monitor outputs can be connected to a bedside monitor and a second pressure cable can be added (see *General Troubleshooting setup guide*)

CAUTION: Federal (United States) law restricts these devices to sale by or on the order of a physician. See instructions for use for full prescribing information, including indications, contraindications, warnings, precautions, and adverse event

BD, Irvine, CA 92618 USA

[bd.com](https://www.bd.com)



BD, the BD Logo, Acumen, Acumen IQ, ClearSight and HemoSphere are trademarks of Becton, Dickinson and Company or its affiliates. All other trademarks are the property of their respective owners. ©2025 BD. All rights reserved. BD-146601 v1.0 US