

# BD Nexiva™

## Closed IV Catheter System—Dual Port

Scan this code to watch a video on how to use the BD Nexiva™ Closed IV Catheter System - Dual Port ▶

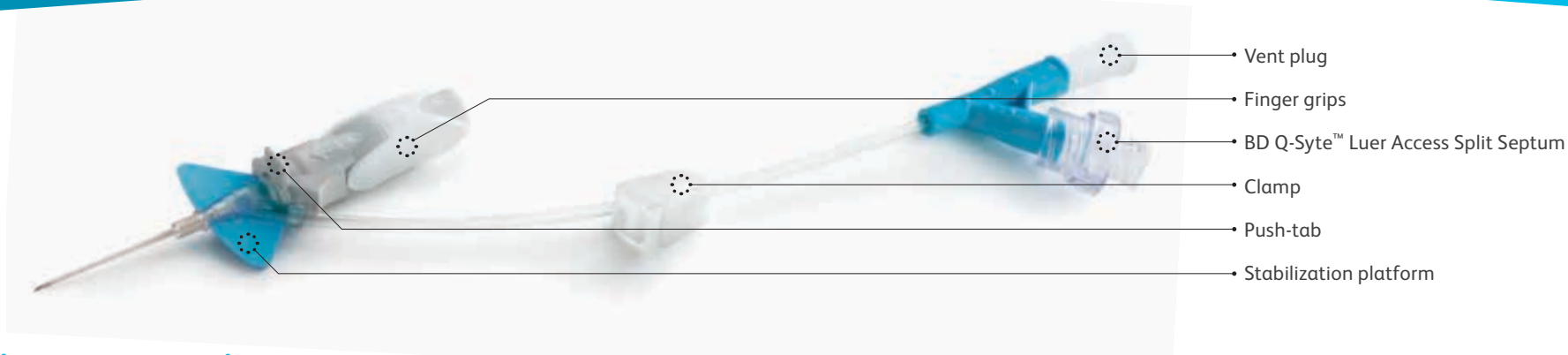

### Points to practice

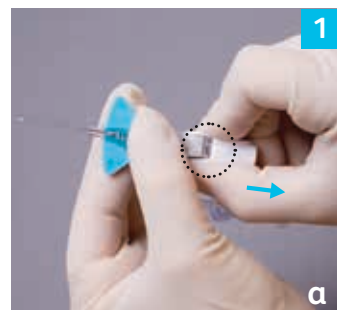

#### 1 Preparation

- Secure the vent plug and BD Q-Syte™ luer access split septum.
- The clamp should not be engaged.
- Twist to remove the needle cover.
- Holding as shown, pull back approximately 1/8" on the finger grips (Fig. 1a).
- Push the finger grips back to their original position so the stabilization platform and finger grips are snugly together (Fig. 1b).

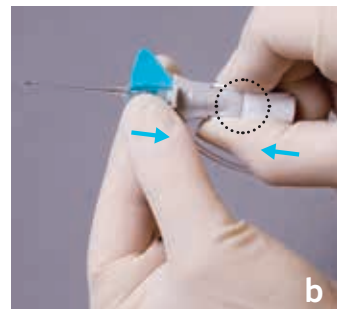

#### 2 Insertion and flashback

- Hold the system as shown and access the vessel (Fig. 2).
- Initial blood return is along the catheter, then up the extension tube. Look at the catheter for initial blood return.
- Lower and advance the entire catheter and needle unit slightly to ensure the catheter tip is within the vessel.



#### 3 Advancement

- Place the index finger pad behind the push-tab and push the catheter off the needle into the vessel (Fig. 3).
- Tip: Do not pull back on the needle during advancement.*

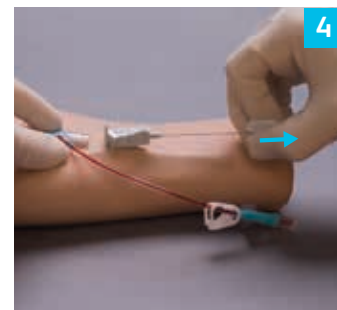

#### 4 Needle removal

- Stabilize the catheter system and pull back on the finger grips until the push-tab component releases from the stabilization platform (Fig. 4).
  - Discard the shielded needle into a puncture-resistant, leak-proof sharps container.
- Tip: Do not hold onto the push-tab component of the device as this will prevent the release of the needle shield.*

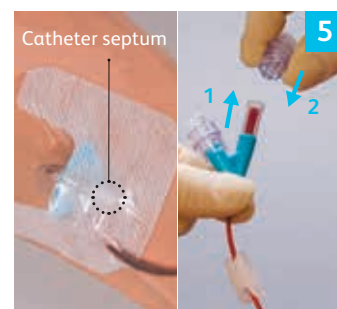

#### 5 Stabilization and preparation for use

- Apply a transparent dressing to cover the septum, allowing maximum use of the extension tubing (Fig. 5).
- Engage the clamp.
- Remove the vent plug and attach the other BD Q-Syte™ device (Fig. 5).

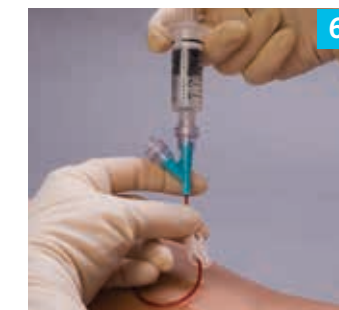

#### 6 Access and flushing/infusion

- Disinfect the BD Q-Syte™ device with an appropriate antiseptic.
- Insert the male luer of a syringe or administration set using a straight-on approach (Fig. 6).
- Release the clamp and flush or start the infusion.
- Secure the extension tubing.



#### 7 Disconnection

- Clamp before disconnecting to minimize the reflux of blood.
  - Hold the BD Q-Syte™ device during disconnection and use a straight-off approach.
- NOTE:** Single lumen. Compatible meds only.

Consult product insert for complete instructions, warnings and cautions.

BD, 9450 S State Street, Sandy, Utah 84070, U.S.

[bd.com](http://bd.com)

BD, the BD logo, Nexiva and Q-Syte are trademarks of Becton, Dickinson and Company or its affiliates. All other trademarks are the property of their respective owners. © 2020 BD. All rights reserved. BD-7816 (11/20)

