

BD PosiFlush™ XS/SF Prefilled Saline Syringe

Points to practice

PosiFlush™ XS/SF Prefilled Saline Syringes are intended to be used FOR FLUSHING ONLY of in-situ peripheral intravenous catheters (PIVCs), peripherally inserted central catheters (PICCs), central venous catheters (CVCs), and implanted venous access ports.

PosiFlush™ XS/SF Prefilled Saline Syringes are not intended for dry product reconstitution, for medication dilution, or where intravenous therapy with sodium chloride is indicated.



PosiFlush™ XS/SF Prefilled Saline Syringe can be used on a sterile field.



Use aseptic technique throughout the procedure.

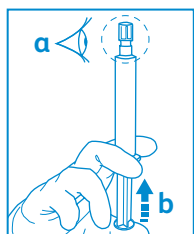

1a Open blister pack and remove syringe. Using sterile technique, place syringe on a sterile field, if applicable. Check that syringe tip cap is in place. Inspect clarity of solution.

1b Depress plunger with tip cap on to release stopper seal.

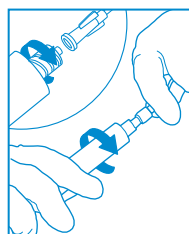

4 Connect the PosiFlush™ XS/SF Prefilled Saline Syringe to vascular access device, taking care that there is no touch contamination of the connection. Ensure secure connection.

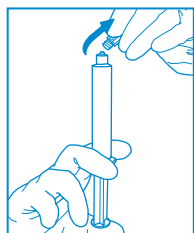

2 Unscrew tip cap from the syringe, ensuring that there is no touch contamination of the syringe luer connection.

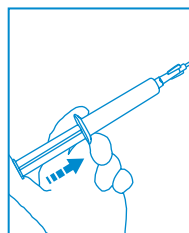

5 Push syringe plunger to inject the required volume of saline following institution's policy. Inject the solution slowly in order to avoid overpressure. In case of plunger resistance, it is recommended that excessive force is not exerted.

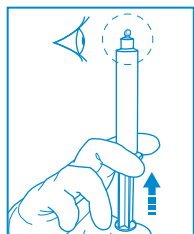

3 Push syringe plunger to expel the air.

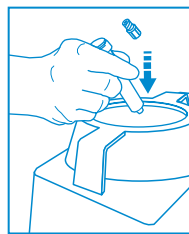

6 After use, dispose of in accordance with recognized procedure in your institution.

Warnings

- Do not use if unit package or content is damaged.
- Do not use if product has been left at freezing temperature.
- Verify the expiration date on the product package or label. Do not use if the product has expired.
- Do not use if syringe tip cap or stopper is damaged.
- Do not use if solution is cloudy or colored, contains a precipitate, or has any type of suspended particulate matters.
- Do not re-use. Re-use may lead to infection or other illness/injury.
- Small parts are a potential choking hazard. After use, discard small parts according to your facility protocol.

This guide is not intended as a replacement for the detailed information contained in the IFU. Please consult BD product labels and package inserts for any indications, contraindications, hazards, warnings, cautions and instructions for use.

BD, Franklin Lakes, NJ, 07417, U.S.

[bd.com](https://www.bd.com)

BD, the BD logo and PosiFlush are trademarks of Becton, Dickinson and Company or its affiliates.
© 2024 BD. All rights reserved. BD-114060 (03/2024)

