

# BD SafetyGlide™ Needle

## Quick reference card

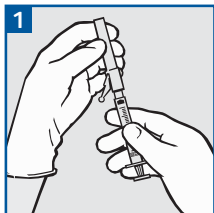

### Attachment

Attach the BD SafetyGlide™ Needle to any standard Luer Lock or Luer slip hypodermic syringe.

Twist until firmly seated to connect to a Luer Lock syringe. Pull shield straight off the needle to avoid damaging the needle point.

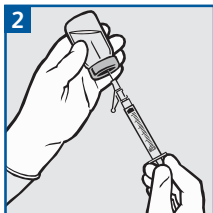

### Aspiration

Draw up medication in accordance with your institution's protocol.

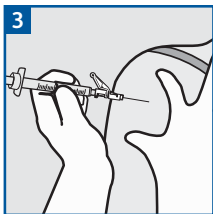

## Injection

Administer medication in accordance with your institution's protocol. For user convenience, the needle's "bevel-up" position is oriented to the lever arm.

### Remember

- Activation of the protective mechanism may cause minimal splatter of any fluid that is remaining on the needle after injection.
- To connect the BD SafetyGlide™ Needle to a Luer slip syringe, push firmly.
- Follow your institution's protocol for aseptic technique and skin preparation.
- Follow your institution's policy for safe disposal of all medical waste.
- Please consult BD product labels and package inserts for any indications, contraindications, hazards, warnings, cautions and Instructions for Use.

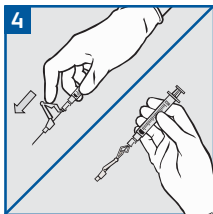

## Activation

Activate safety mechanism immediately after removal from the patient by pushing the lever arm completely forward until the needle tip is completely covered.

Use one-handed technique and activate away from self and others. Visually confirm that the lever arm has fully advanced and the needle tip is covered.

After activation or if unable to activate, discard immediately in an approved sharps collector.