

# BD SafetyGlide™ Syringe

for insulin, TB and allergy

## Quick reference card

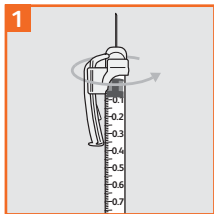

### Preparation

Pull the shield straight off the needle. Rotate the safety arm as needed to read the scale.

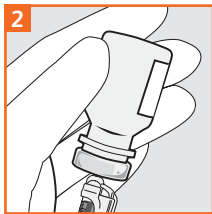

### Aspiration

Draw up medication in accordance with your institution's protocol.

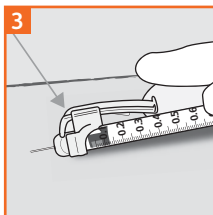

## Injection

To facilitate a low angle injection, rotate the safety arm so that it is oriented to the needle bevel.

Administer medication in accordance with your institution's protocol.

### Remember

- Follow your institution's protocol for aseptic technique and skin preparation.
- Follow your institution's policy for safe disposal of all medical waste.
- Please consult BD product labels and package inserts for any indications, contraindications, hazards, warnings, cautions and Instructions for Use.

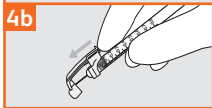
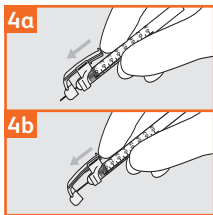

## Activation

**4a.** After injection, apply a single finger stroke to activate the safety arm by moving it completely forward until the safety arm is fully extended and the needle tip is covered.

**4b.** Use one-handed technique and activate away from self and others. Visually confirm that the safety arm has fully advanced and the needle tip is covered. After activation or if unable to activate, immediately discard into an approved sharps collector after single use.