

# BD™ Blunt Fill and BD™ Blunt Filter Needles

## Quick reference card

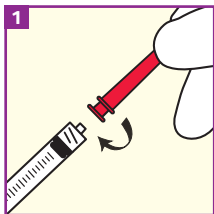

### Attachment

Attach the BD™ Blunt Fill or BD™ Blunt Filter Needle to any standard Luer Lock or Luer slip hypodermic syringe. Twist until firmly seated to connect to a Luer Lock syringe. Pull the needle shield straight off the needle.

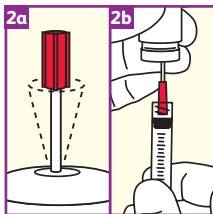

### Aspiration

**2a.** Puncture stopper with the BD™ Blunt Fill Needle.

Note: For glass ampules, use the BD™ Blunt Filter Needle.

**2b.** Draw up medication in accordance with your institution's protocol.

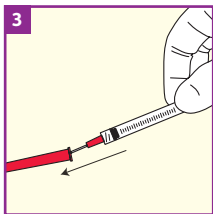

## Recapping

Passively recap BD™ Blunt Fill or BD™ Blunt Filter Needle.

### Remember

- The BD™ Blunt Fill and BD™ Blunt Filter Needles are not to be used for skin injections.
- Follow your institution's protocol for aseptic technique.
- Follow your institution's policy for safe disposal of all medical waste.
- For glass ampules, use the BD™ Blunt Filter Needle.
- The BD™ Blunt Filter Needle is a one-way filter and should be removed once fluid is filtered into the syringe.
- To connect the BD™ Blunt Fill or BD™ Blunt Filter Needle to a Luer slip syringe, push firmly.
- Please consult BD product labels and package inserts for any indications, contraindications, hazards, warnings, cautions and Instructions for Use.

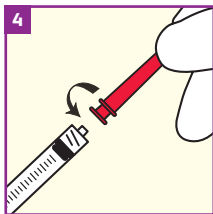

## Disposal

Detach needle from the syringe and immediately discard into an approved sharps collector after single use.

### BD™ Blunt Fill Needle

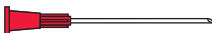

### BD™ Blunt Filter Needle



Note hub color difference between the BD™ Blunt Filter and the BD™ Blunt Fill Needle.

The BD™ Blunt Fill Needle may be recommended based upon your institution's policies and procedures for medication aspiration.