

## Points to Practice

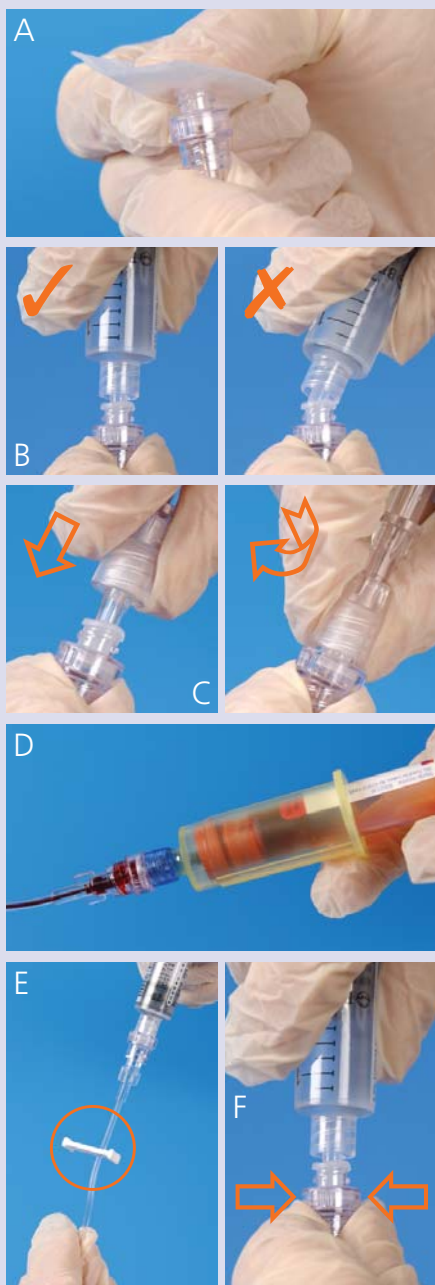

### 1. Disinfect

- Disinfect the silicone septum with an appropriate antiseptic agent.
- Disinfect prior to each access. (A)

### 2. Access

#### **Syringe:**

- Access the BD Q-Syte Luer Access device with a luer lock or luer slip syringe.
- Connect using a straight-on approach. (B)

Note: Do not use needles or blunt cannulae with the BD Q-Syte Luer Access device.

#### **Administration Set:**

- When using an administration set with a spin nut, insert the slip luer into the BD Q-Syte Luer Access device. Then secure the connection with the spin nut. (C)

#### **Blood Withdrawal:**

- Use BD Vacutainer® Luer-Lok™ Access Device. (D)

### 3. Flush

- Flush according to facility policy or until device is clear. If unable to clear replacement is recommended.
- To minimise reflux of blood into the vascular access device, it is recommended to clamp before disconnecting. (E)
- When disconnecting, hold the BD Q-Syte Luer Access device firmly in place to prevent accidental removal. (F)

NOTE: Refer to package insert for precautions and complete instructions for use.

The BD Q-Syte Luer Access device has a luer penetrating split septum design that provides high flow rates, fluid path visualisation, and consistent dependable performance.

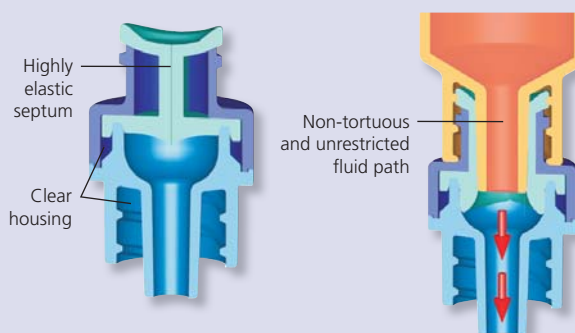

#### **BD Medical**

**Australia:** 4 Research Park Drive, Macquarie University Research Park, North Ryde, NSW 2113. Toll Free telephone: 1800 656 100.

**New Zealand:** 8 Pacific Rise, Mt Wellington, Auckland, New Zealand. Toll Free telephone: 0800 572 468.